

BLUE SCREEN (OF DEATH)

brought to you by the

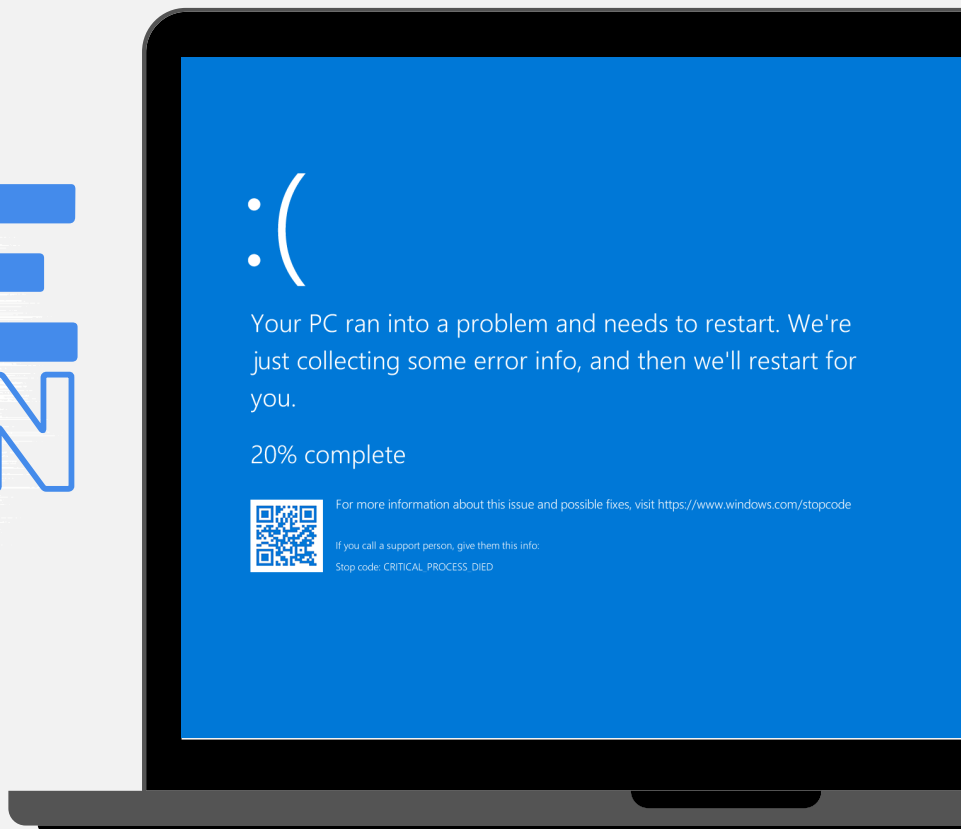

THE BAD NEWS

The **blue screen** or **blue screen of death (BSOD)** is one of most dreaded computer problems of users. It is often caused by a minor glitch, failure of a system, fatal system errors or system crash.

THE GOOD NEWS

It is not always fatal, so before you despair, try these quick fixes.

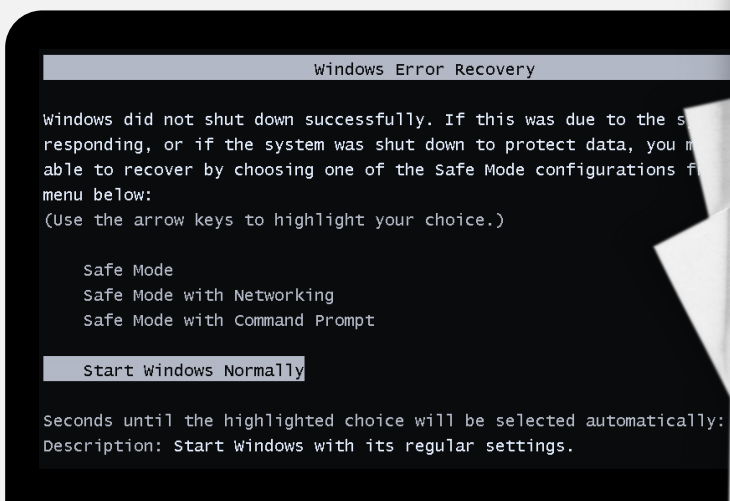

Wait until Windows automatically restarts or displays startup menu. Press **“Start Windows Normally.”**

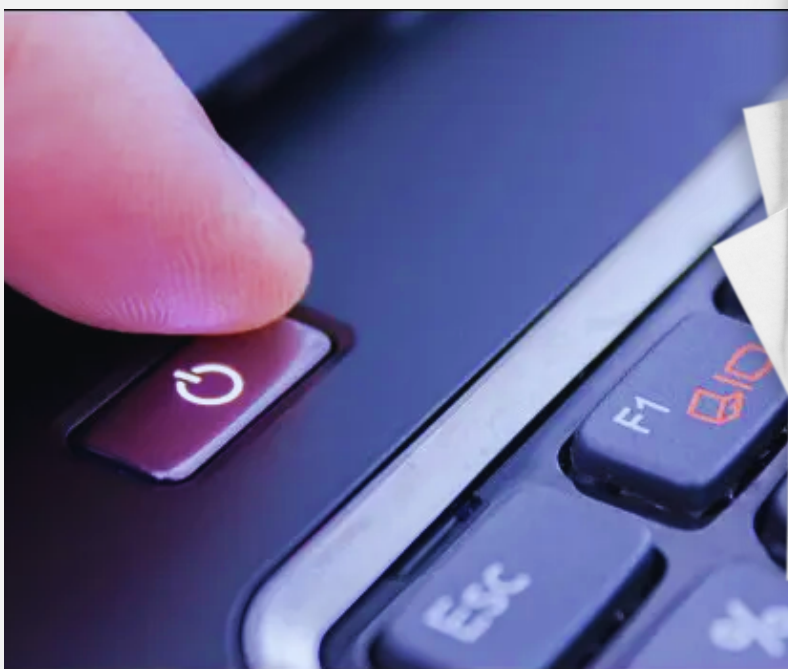

Press **Ctrl & Alt & Del** keys at the same time to restart the machine. As an alternative, press and hold the power button to force shut down. Switch your computer back on and select **“Start Windows Normally.”**

NEED HELP?

✉ helpdesk@dlsud.edu.ph

☎ 3225

INFORMATION AND COMMUNICATIONS TECHNOLOGY CENTER

De La Salle University - Dasmariñas

+63 (46) 481.1900 Local 3225

✉ ictc@dlsud.edu.ph